

MINNESOTA DEPARTMENT OF TRANSPORTATION



CONSTRUCTION PLAN FOR: PLANT MIXED BITUMINOUS WEARING COURSE
AND AGGREGATE SHOULDERS

COUNTY STATE AID HIGHWAY 7

BETWEEN C.S.A.H. 15 NORTH AND U.S. 75
FROM: S.W. CORNER OF SEC. 15-107-46
TO: N.E. CORNER OF SEC. 24-107-46
3 MILES NORTH OF THE CITY OF PIPESTONE

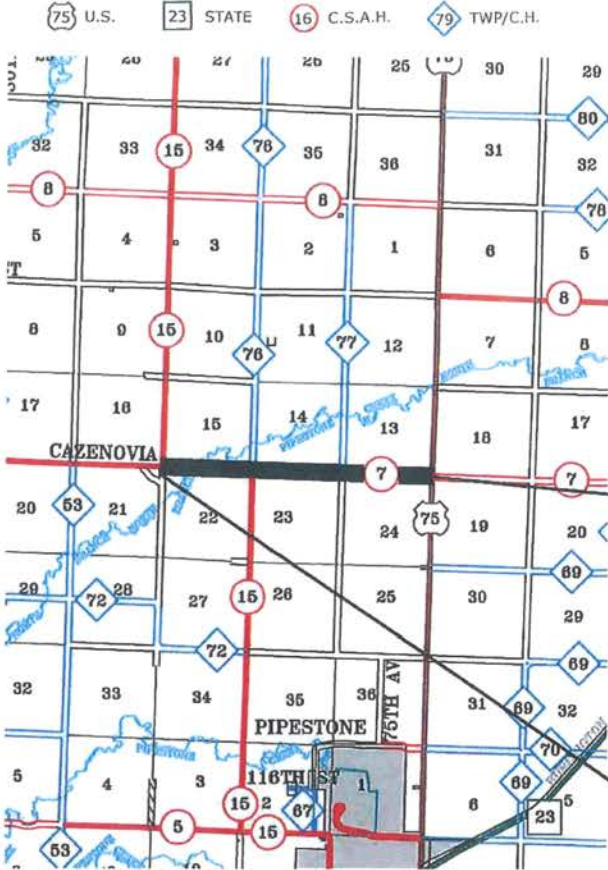

PROJECT NO. S.A.P. 059-607-022

GROSS LENGTH 15855.10 FEET 3.003 MILES
BRIDGES LENGTH --- FEET --- MILES
EXCEPTIONS LENGTH --- FEET --- MILES
NET LENGTH 15855.10 FEET 3.003 MILES

INDEX OF SHEETS

- SHEET NO. 1 TITLE SHEET & LAYOUT MAP
- SHEET NO. 2 ESTIMATED QUANTITIES
- SHEET NO. 3 TYPICAL SECTIONS AND DETAILS
- SHEET NO. 4 DETAILS

THIS PLAN CONTAINS 4 SHEETS

END S.A.P. 059-607-022
STA. 317+00.70

STA. 158+45.6 TO STA. 211+39.4
SURFACED UNDER S.A.P. 59-607-17 (2003)
GRADED AND SURFACED UNDER S.A.P. 059-607-016 (1992)

STA. 211+39.4 TO STA. 317+00.7
SURFACED UNDER S.A.P. 59-607-17 (2003)
SURFACED UNDER S.A.P. 59-607-10 (1985)
SURFACED UNDER S.A.P. 59-607-08 (1972)
GRADED UNDER S.A.P. 59-607-07 (1971)

BEGIN S.A.P. 059-607-022
STA. 158+45.60

STOPPING SIGHT DISTANCE
BASED ON:
3.5' HEIGHT OF EYE
2.0' HEIGHT OF OBJECT

FUNCTIONAL CLASSIFICATION
MAJOR COLLECTOR
2 TRAFFIC LANES

ALL APPLICABLE FEDERAL, STATE AND LOCAL LAWS AND ORDINANCES WILL BE COMPLIED WITH, IN THE CONSTRUCTION OF THIS PROJECT.

SIGNATURE: [Signature] PRINTED NAME: DAVID J. HALBERSMA

DESIGN ENGINEER: I HEREBY CERTIFY THAT THIS PLAN WAS PREPARED BY ME OR UNDER MY DIRECT SUPERVISION, AND THAT I AM A DULY LICENSED PROFESSIONAL ENGINEER UNDER THE LAWS OF THE STATE OF MINNESOTA.

DATE: 12/27/17 LICENSE NUMBER: 19952

APPROVED: [Signature] PIPESTONE COUNTY ENGINEER

DATE: 12/27/17

DISTRICT STATE AID ENG. REVIEWED FOR COMPLIANCE WITH STATE-AID RULES/POLICY

STATE AID ENGINEER APPROVED FOR STATE AID FUNDING

DATE: 1-2-18

DATE: 1-2-18

DESIGN DESIGNATION

RURAL
ADT 296 (2018)
ADT 385 (2038)
HCACT (HEAVY COMMERCIAL) <150
9 TON DESIGN 10 "R" VALUE 130 %S.F.
EN18 36 SHOULDER WIDTH 3'
DESIGN SPEED 50 MPH
DESIGN SPEED NOT ACHIEVED AT:
STA. _____ TO STA. _____ MPH

GOVERNING SPECIFICATIONS

THE 2018 EDITION OF THE MINNESOTA DEPARTMENT OF TRANSPORTATION 'STANDARD SPECIFICATIONS FOR CONSTRUCTION' SHALL GOVERN

MINN. PROJ. NO. _____ COUNTY PROJ. NO. _____
STATE PROJ. NO. _____ S.A.P. 059-607-022

